

CENTRAL PLAZA

STANDARD TARIFF FOR EXTENSION OF AIR-CONDITIONING SERVICE

Each floor is divided into six zones in terms of air-conditioning supply. Standard tariff is as follows:-

No. of Zone	Rate (HK\$ per hour)
1	\$270.00
2	\$330.00
3	\$390.00
4	\$450.00
5	\$510.00
6 (whole floor)	\$570.00

The above rate will apply to ad-hoc request for extended air-conditioning service.

For long term service with regular pattern of service (such as daily, weekly or monthly), the following will apply:-

Length of Commitment	Discount on Standard Tariff
- Minimum 3 months & upto 6 months	10%
- Longer than 6 months	20%

* The applicant has to reimburse the tariff difference between the standard and discounted tariff if applicant terminates the service during the commitment period.

Remarks:

- 1) Application should be made **24 hours in advance**.
 - 2) A minimum charge (charges will be calculated to the nearest hours)
 - Mondays to Saturdays # : **Two(2) consecutive hours per application**
 - Public Holidays and Sundays : **Four(4) consecutive hours per application**
 - 3) Normal service hours – Mondays to Fridays : 0800 to 1900 hours
 – Saturdays : 0800 to 1300 hours
- # Extension of air-conditioning service should be started right after the normal service hours.

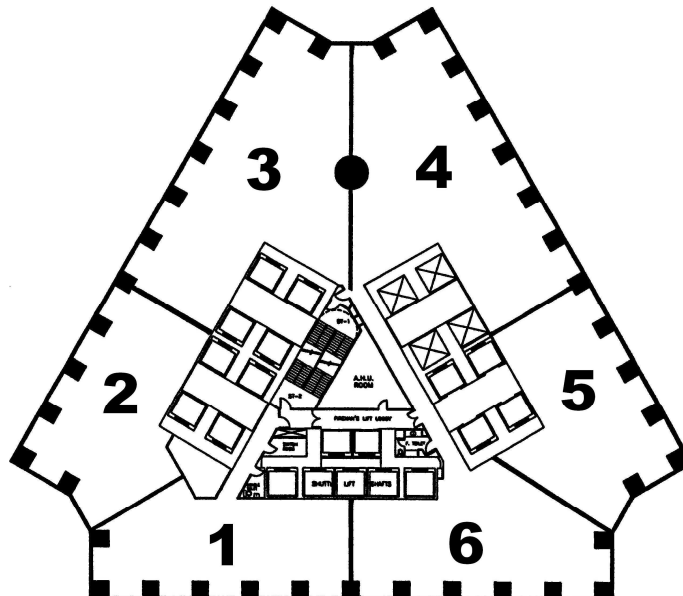

**TYPICAL A/C ZONING PLAN
CENTRAL PLAZA**